



7 HEREFORD DRIVE, BRAINTREE CM7

OFFERS IN EXCESS OF £475,000

4 Bedrooms | 2 Bathrooms | 4 Receptions



Floor Plan

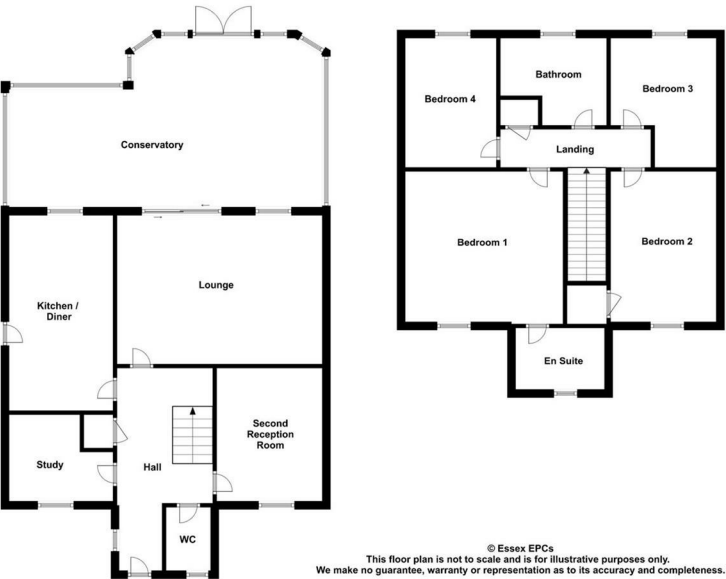

Area Map



Accommodation

- FOUR DOUBLE BEDROOMS
- FOUR RECEPTION ROOMS
- 25' CONSERVATORY EXTENSION
- DOUBLE GARAGE
- STUDY/PLAYROOM
- NEWLY FITTED KITCHEN SUITE
- EN-SUITE TO MASTER BEDROOM
- SOUTH FACING REAR GARDEN
- DOUBLE DRIVEWAY
- EASY ACCESS TO A120

Viewing

Please contact us on 01376 386555 if you wish to arrange a viewing appointment for this property, or require further information.

Energy Efficiency Graph

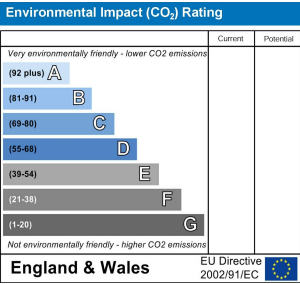
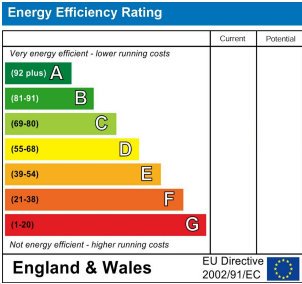

**Phone:** 01376 386555  
**Email:** [info@branocsestates.co.uk](mailto:info@branocsestates.co.uk)  
**Website:** [www.branocsestates.co.uk](http://www.branocsestates.co.uk)

Phoenix House 5 New Street  
Braintree  
Essex  
CM7 1ER

Branocs endeavour to maintain accurate depictions of properties in Virtual Tours, Floor Plans and descriptions, however, these are intended only as a guide and purchasers must satisfy themselves by personal inspection.

